

**LEGEND:**

- EXTENTS OF PART VIII APPLICATION —
- PROPOSED STORM SEWER —
- PROPOSED STORM SEWER MANHOLE ●
- PROPOSED COMBINED SEWER MANHOLE ●
- PROPOSED GULLY
- PROPOSED 150mm GULLY CONNECTION PIPE —
- PROPOSED FOUL SEWER —
- PROPOSED FOUL SEWER MANHOLE ●

**NOTES:**

- PART VIII
- OSI Map Ref: 5430-11

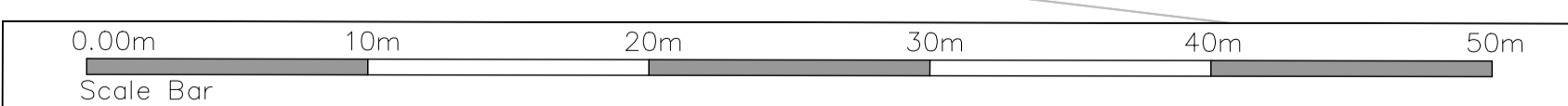

Client



**Comhairle Contae Thiobraid Árann**  
Tipperary County Council

**General Notes**

(i) Hard copies, dwf and pdf will form a controlled issue of the drawing. All other formats (dwg etc.) are deemed to be an uncontrolled issue and any work carried out based on these files is at the recipients own risk. RPS will not accept any responsibility for any errors from the use of these files, either by human error by the recipient, listing of the un-dimensioned measurements, compatibility with the recipients software, and any errors arising when these files are used to aid the recipients drawing production, or setting out on site.

(ii) DO NOT SCALE, use figured dimensions only.

(iii) This drawing is the property of RPS, it is a project confidential classified document. It must not be copied used or its contents divulged without prior written consent. The needs and expectations of client and RPS must be considered when working with this drawing.

(iv) Information including topographical survey, geotechnical investigation and utility detail used in the design have been provided by others.

(v) All Levels refer to Ordnance Survey Datum, Malin Head.

Rev	Date	Drn Cnk	Amendment / Issue	App
P01	10.07.20	Mg	PART VIII APPLICATION	RPS



Model File Identifier  
**MGT0491**

Scale	1:250 @ A1 1:500 @ A3	Project	CLONMEL TOWN URBAN DESIGN		
Created on	JULY 2020	Title	DRAINAGE		
Sheets	01 of 08	Drawing No.	DR0001-01	Status	S1
File Identifier	MGT0491-RPS-00-XX-DR-C-DR0001	Rev	P01		

I:\a\w-bp-011\Work\_Town Urban Design\DRMGT0491-RPS-00-XX-M2-C-DR0001 Part 6 Drainage.dwg

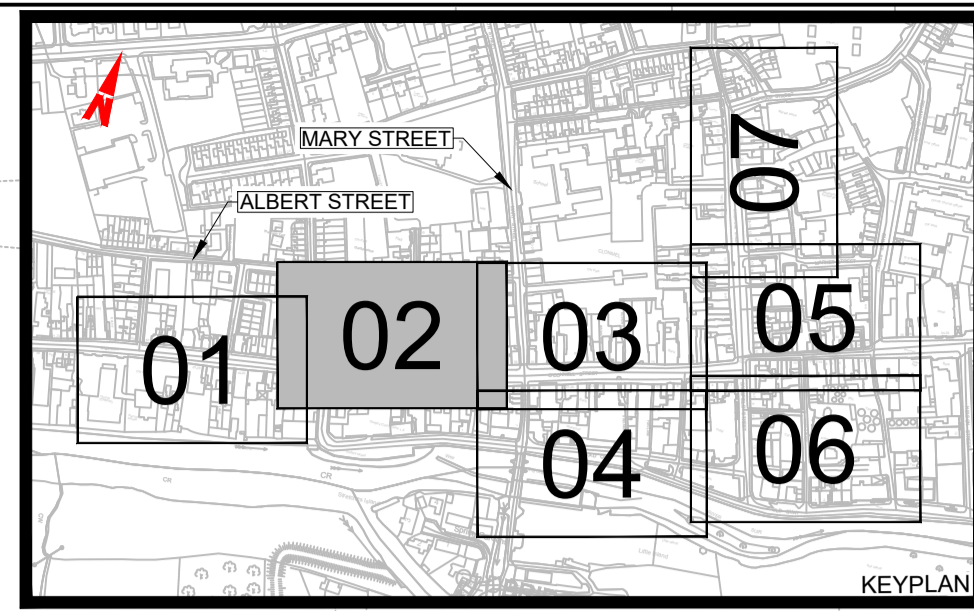

**LEGEND:**

- EXTENTS OF PART VIII APPLICATION —
- PROPOSED STORM SEWER —
- PROPOSED STORM SEWER MANHOLE ●
- PROPOSED COMBINED SEWER MANHOLE ●
- PROPOSED GULLY ■
- PROPOSED 150mm GULLY CONNECTION PIPE —
- PROPOSED FOUL SEWER —
- PROPOSED FOUL SEWER MANHOLE ●

**NOTES:**

- PART VIII
- OSI Map Ref: 5430-11

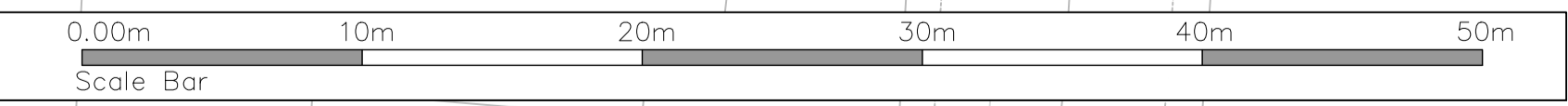
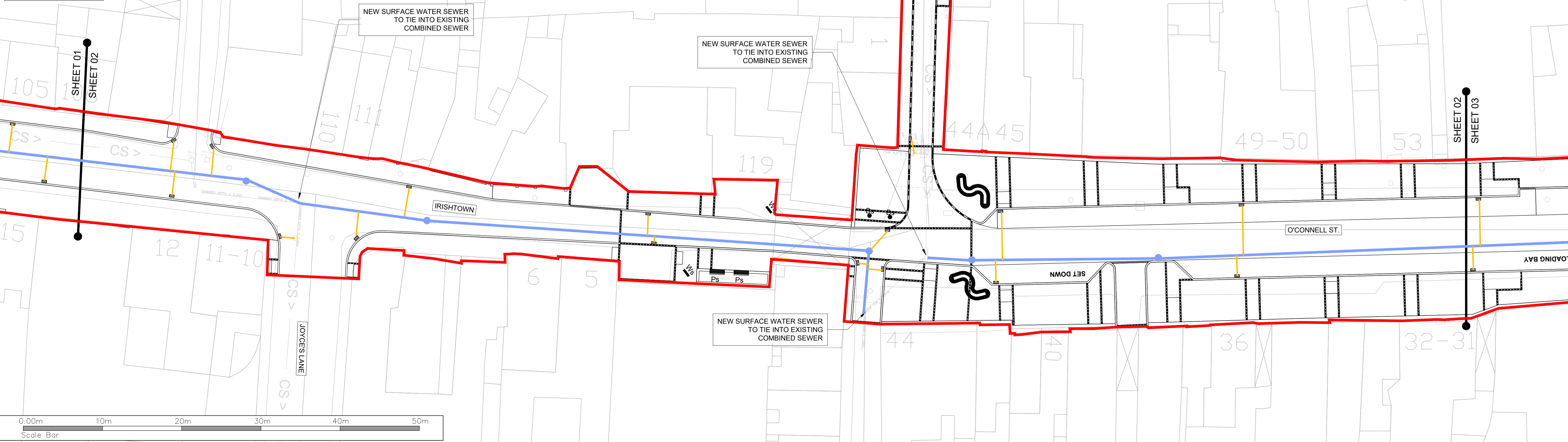

Client



**Comhairle Contae Thiobraid Árann**  
Tipperary County Council

**General Notes**

(i) Hard copies, dwf and pdf will form a controlled issue of the drawing. All other formats (dwg etc.) are deemed to be an uncontrolled issue and any work carried out based on these files is at the recipients own risk. RPS will not accept any responsibility for any errors from the use of these files, either by human error by the recipient, listing of the un-dimensioned measurements, compatibility with the recipients software, and any errors arising when these files are used to aid the recipients drawing production, or setting out on site.

(ii) DO NOT SCALE, use figured dimensions only.

(iii) This drawing is the property of RPS, it is a project confidential classified document. It must not be copied used or its contents divulged without prior written consent. The needs and expectations of client and RPS must be considered when working with this drawing.

(iv) Information including topographical survey, geotechnical investigation and utility detail used in the design have been provided by others.

(v) All Levels refer to Ordnance Survey Datum, Malin Head.

Rev	Date	Dim Chk	Amendment / Issue	App
P01	10.07.20	Mg	PART VIII APPLICATION	P0



Model File Identifier  
MGT0491

Scale  
1:250 @ A1  
1:500 @ A3

Created on  
JULY 2020

Sheets  
02 of 08

Project	CLONMEL TOWN URBAN DESIGN		
Title	DRAINAGE		
File Identifier	Drawing No.	Status	Rev
MGT0491-RPS-00-XX-DR-C-DR0001	DR0001-02	S1	P01

I:\aibp-01\Work\_Town Urban Design\DRMGT0491-RPS-00-XX-M2-C-DR0001 Part 6 Drainage.dwg

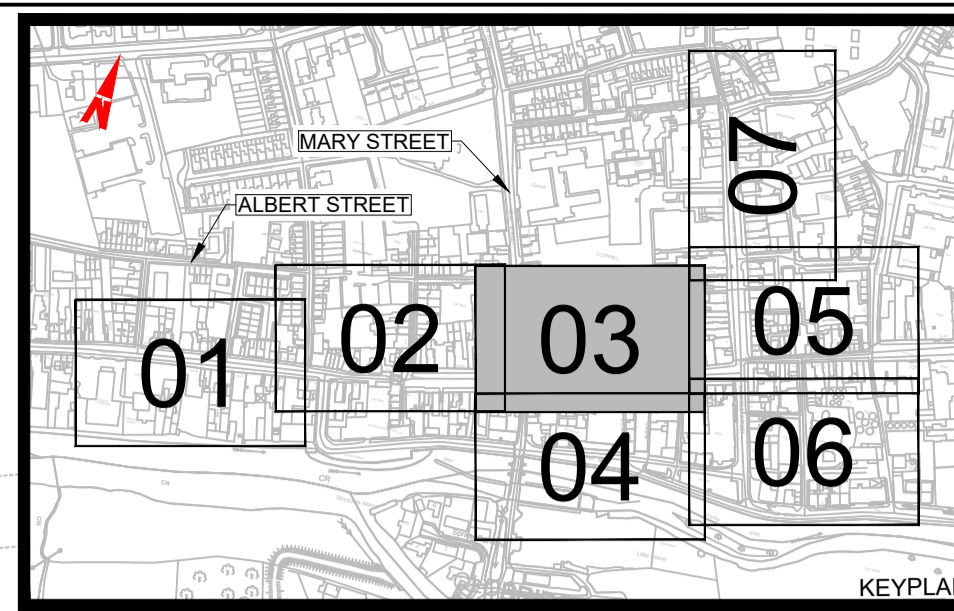

**LEGEND:**

- EXTENTS OF PART VIII APPLICATION —
- PROPOSED STORM SEWER —
- PROPOSED STORM SEWER MANHOLE ●
- PROPOSED COMBINED SEWER MANHOLE ●
- PROPOSED GULLY
- PROPOSED 150mm GULLY CONNECTION PIPE —
- PROPOSED FOUL SEWER —
- PROPOSED FOUL SEWER MANHOLE ●

**NOTES:**

- PART VIII
- OSI Map Ref: 5430-11

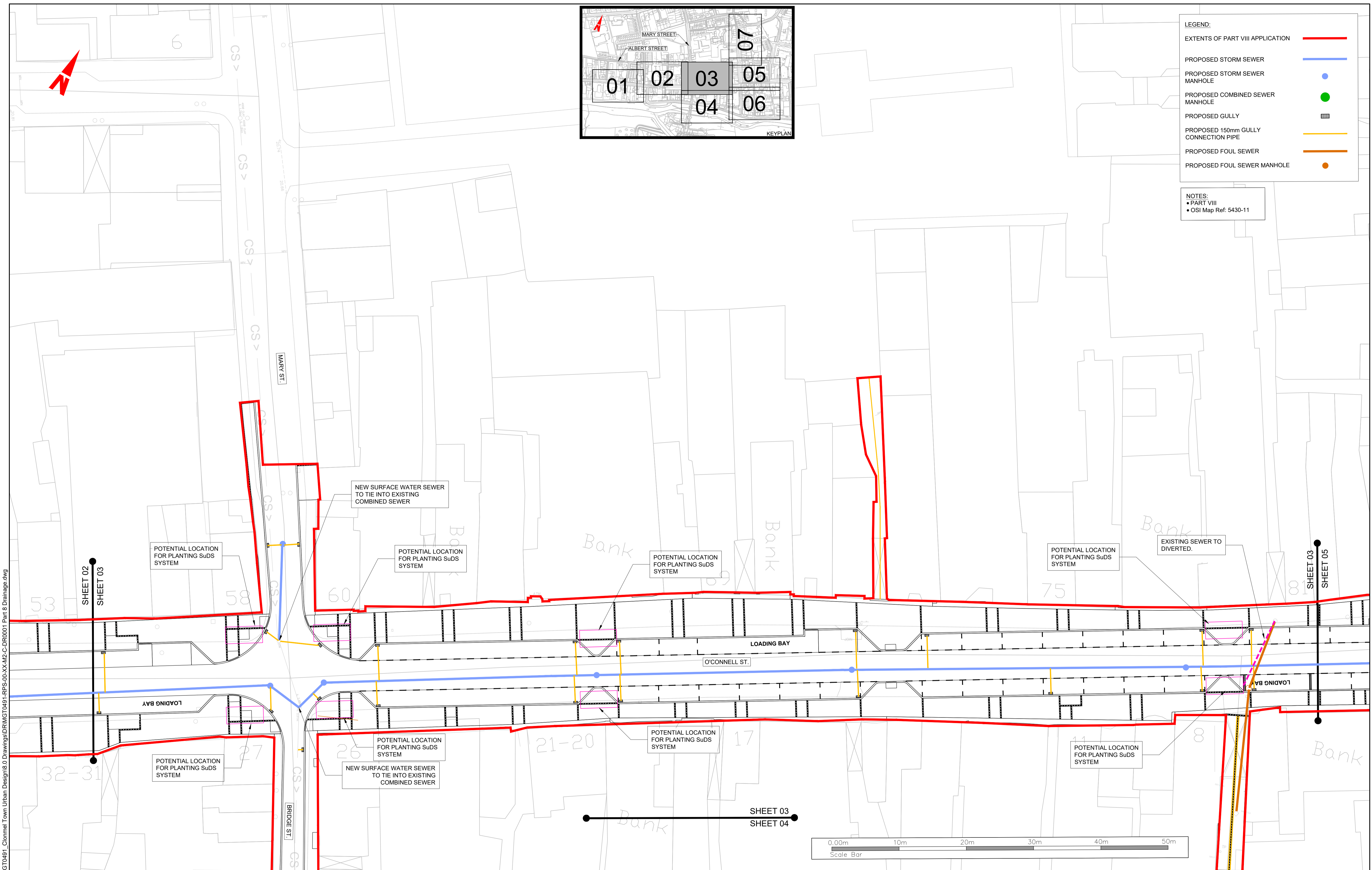

I:\gair-bp-011\Work\_Town Urban Design\DRMGT0491-RPS-00-XX-M2-C-DR0001 Part 6 Drainage.dwg

Client

**Comhairle Contae Thiobraid Árann**  
Tipperary County Council

**General Notes**

(i) Hard copies, dwf and pdf will form a controlled issue of the drawing. All other formats (dwg etc.) are deemed to be an uncontrolled issue and any work carried out based on these files is at the recipient's own risk. RPS will not accept any responsibility for any errors from the use of these files, either by human error by the recipient, listing of the un-dimensioned measurements, compatibility with the recipient's software, and any errors arising when these files are used to aid the recipient's drawing production, or setting out on site.

(ii) DO NOT SCALE, use figured dimensions only.

(iii) This drawing is the property of RPS, it is a project confidential classified document. It must not be copied used or its contents divulged without prior written consent. The needs and expectations of client and RPS must be considered when working with this drawing.

(iv) Information including topographical survey, geotechnical investigation and utility detail used in the design have been provided by others.

(v) All Levels refer to Ordnance Survey Datum, Malin Head.

Rev	Date	Drawn By	Amendment / Issue	App
P01	10.07.20	MJG	PART VIII APPLICATION	PS

Model File Identifier  
**MGT0491**

Scale	1:250 @ A1 1:500 @ A3
Created on	JULY 2020
Sheets	03 of 08

Project	CLONMEL TOWN URBAN DESIGN		
Title	DRAINAGE		
Drawing No.	DR0001-03	Status	S1
Rev		Rev	P01

32-31



SHEET 03  
SHEET 04

Bank

Westcourt  
1-24

SHEET 04  
SHEET 06

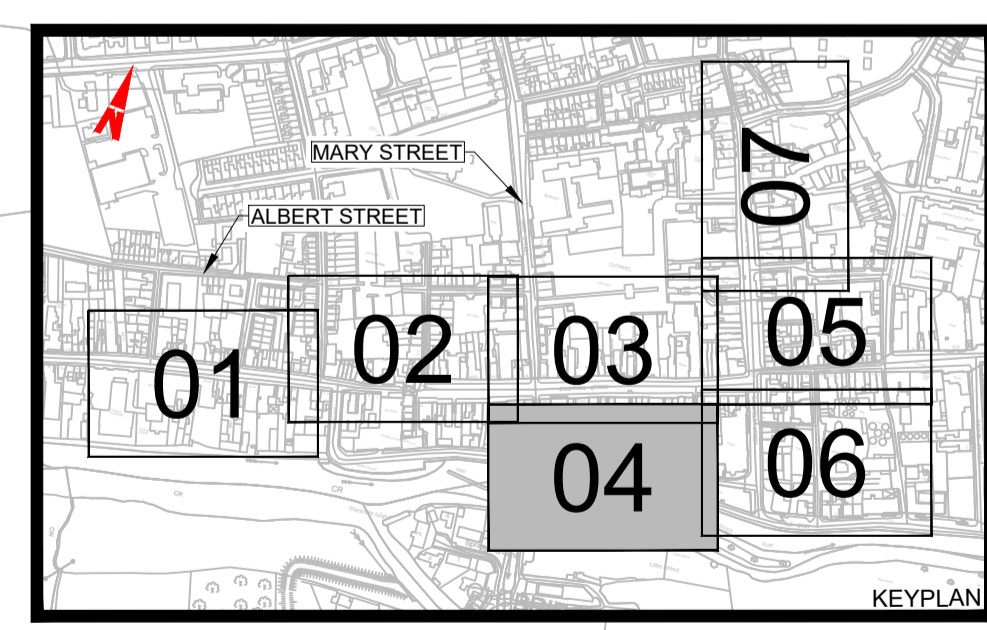
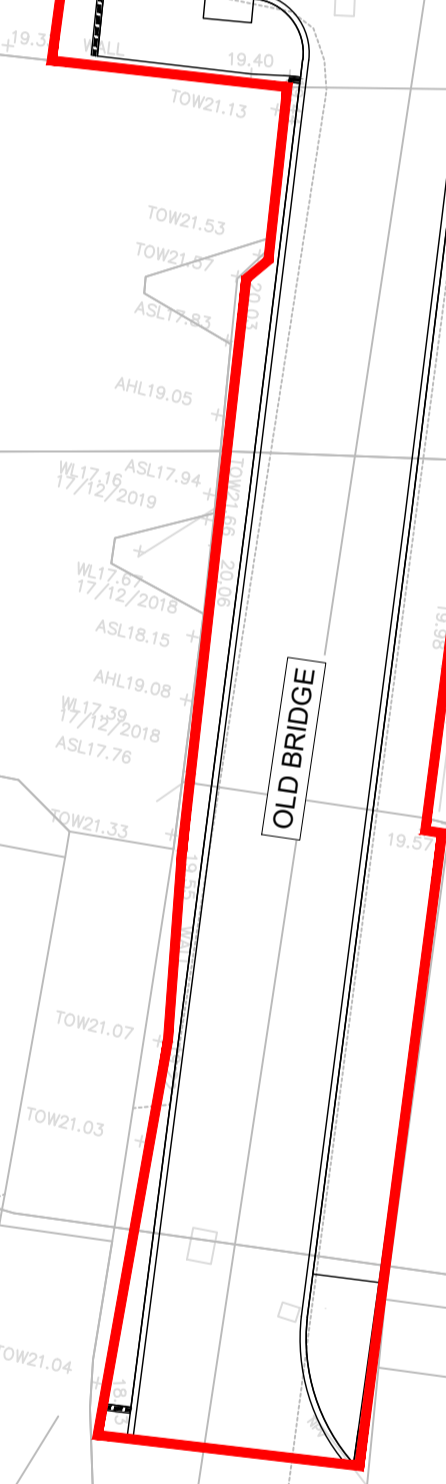
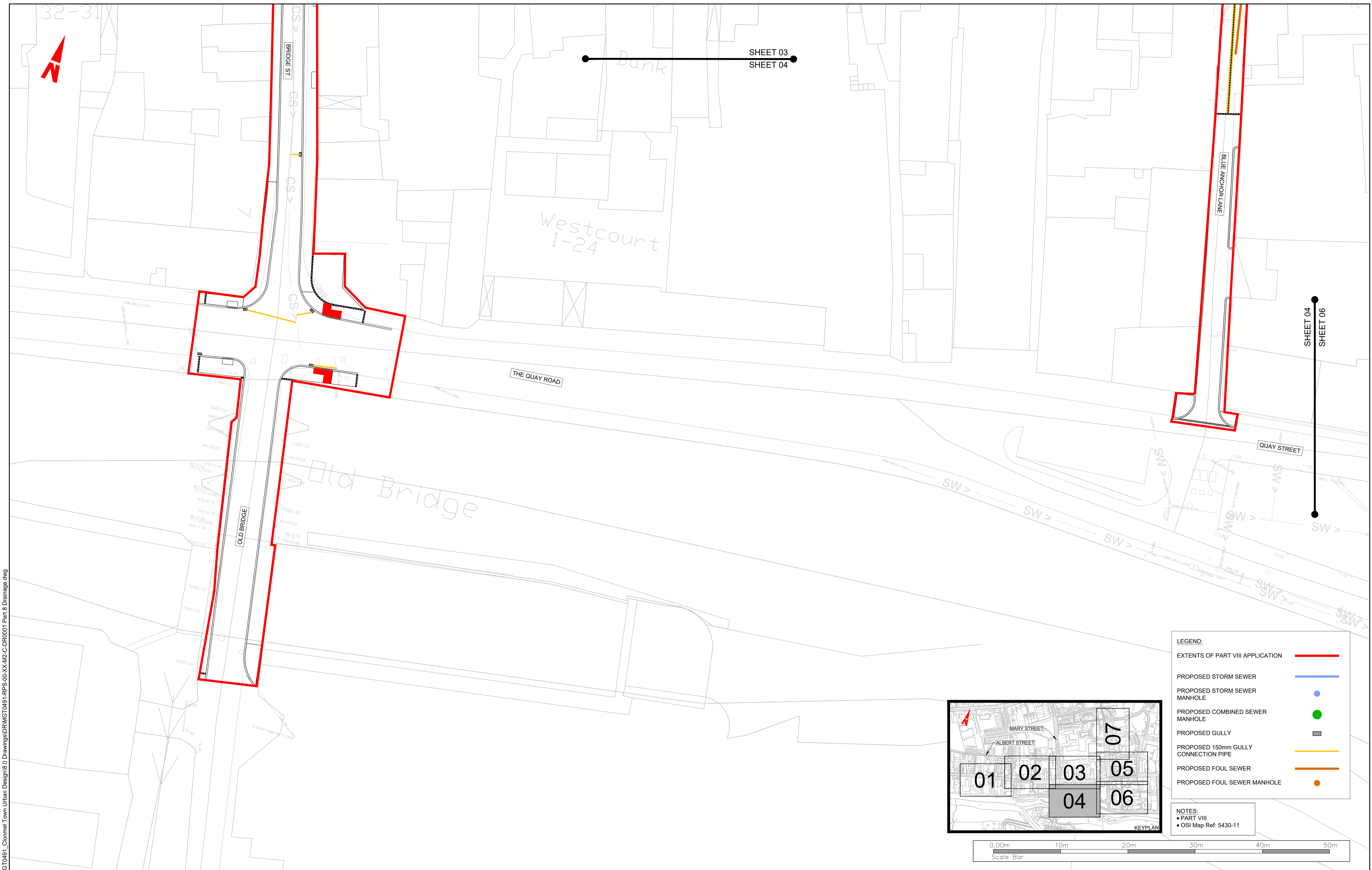

**LEGEND:**

- EXTENTS OF PART VIII APPLICATION (Red line)
- PROPOSED STORM SEWER (Blue line)
- PROPOSED STORM SEWER MANHOLE (Blue circle)
- PROPOSED COMBINED SEWER MANHOLE (Green circle)
- PROPOSED GULLY (Grey square)
- PROPOSED 150mm GULLY CONNECTION PIPE (Yellow line)
- PROPOSED FOUL SEWER (Orange line)
- PROPOSED FOUL SEWER MANHOLE (Orange circle)

**NOTES:**

- PART VIII
- OSI Map Ref: 5430-11

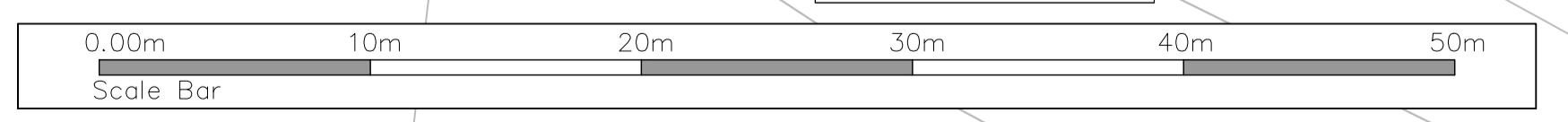

Client

**Comhairle Contae Thiobraid Árann**  
Tipperary County Council

**General Notes**

(i) Hard copies, dwf and pdf will form a controlled issue of the drawing. All other formats (dwg etc.) are deemed to be an uncontrolled issue and any work carried out based on these files is at the recipients own risk. RPS will not accept any responsibility for any errors from the use of these files, either by human error by the recipient, listing of the un-dimensioned measurements, compatibility with the recipients software, and any errors arising when these files are used to aid the recipients drawing production, or setting out on site.

(ii) DO NOT SCALE, use figured dimensions only.

(iii) This drawing is the property of RPS, it is a project confidential classified document. It must not be copied used or its contents divulged without prior written consent. The needs and expectations of client and RPS must be considered when working with this drawing.

(iv) Information including topographical survey, geotechnical investigation and utility detail used in the design have been provided by others.

(v) All Levels refer to Ordnance Survey Datum, Malin Head.

PO1	10.07.20	Me	PART VIII APPLICATION	PS
Rev	Date	Drn Chk	Amendment / Issue	App

Model File Identifier  
MGT0491

Scale	1:250 @ A1 1:500 @ A3
Created on	JULY 2020
Sheets	04 of 08

Project		CLONMEL TOWN URBAN DESIGN	
Title		DRAINAGE	
Drawing No.	Status	Rev	
DR000104	S1	P01	

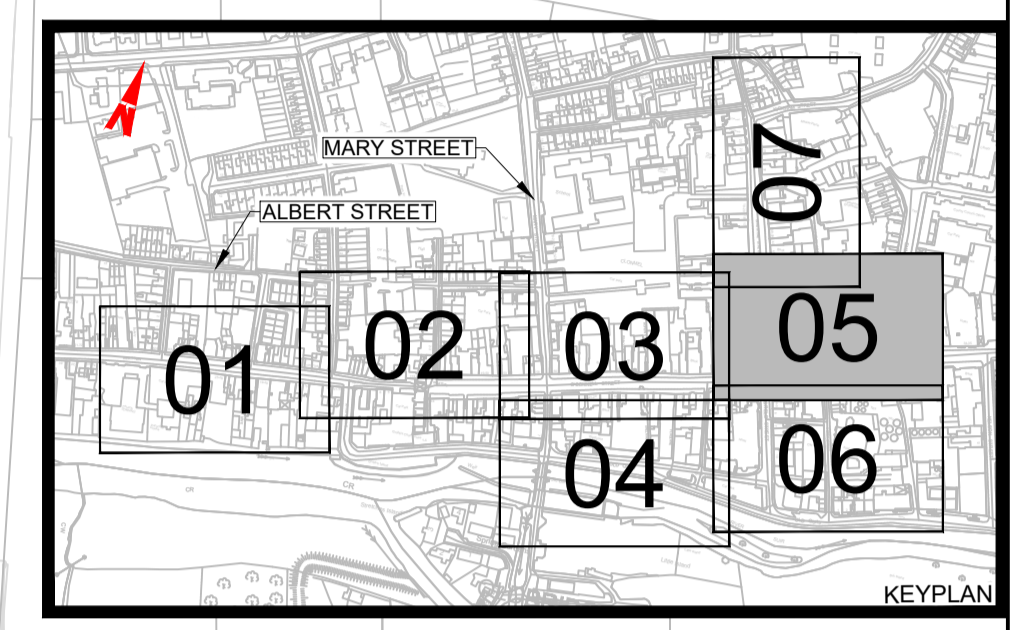
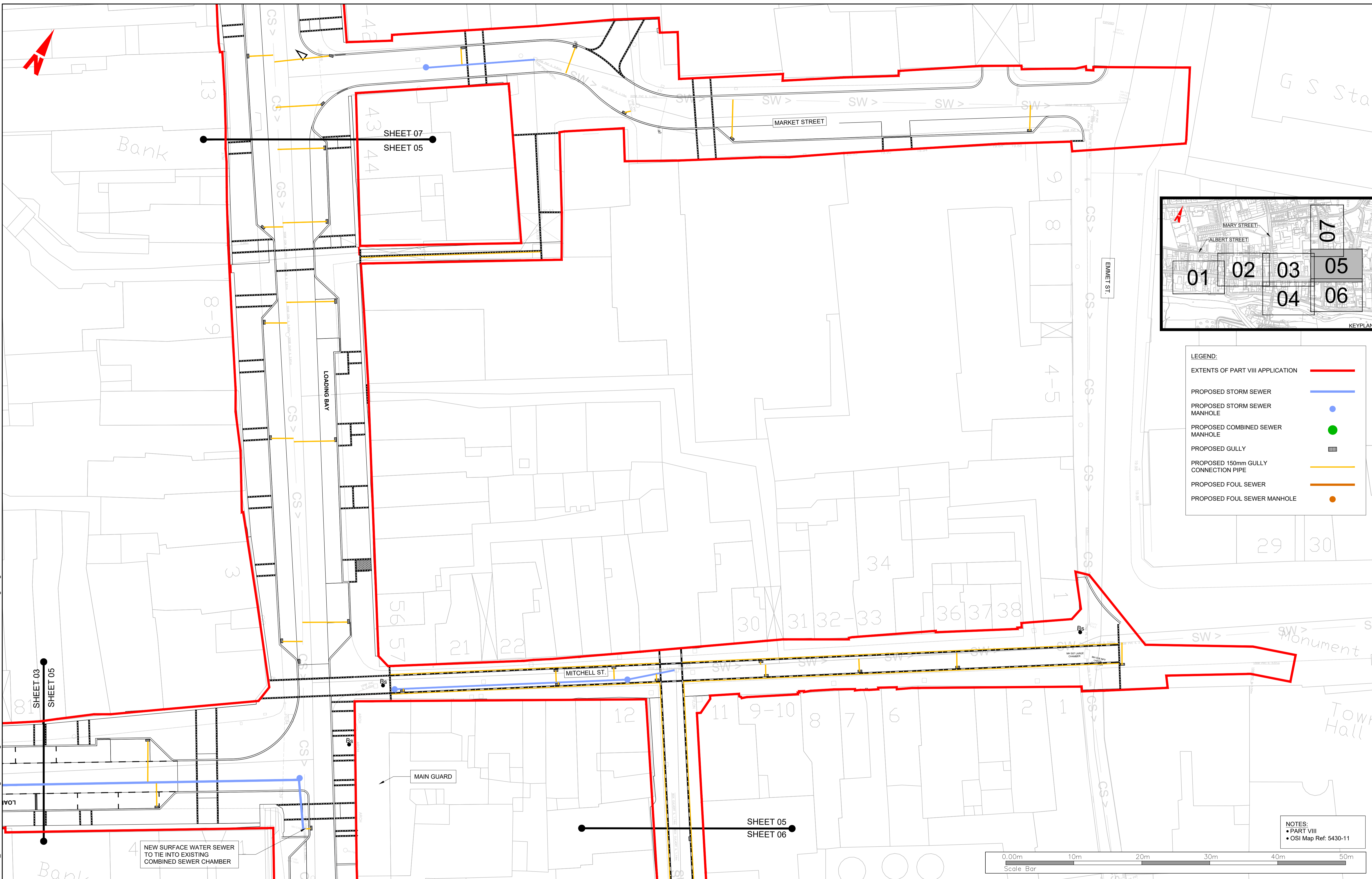

**LEGEND:**

- EXTENTS OF PART VIII APPLICATION —
- PROPOSED STORM SEWER —
- PROPOSED STORM SEWER MANHOLE ●
- PROPOSED COMBINED SEWER MANHOLE ●
- PROPOSED GULLY
- PROPOSED 150mm GULLY CONNECTION PIPE —
- PROPOSED FOUL SEWER —
- PROPOSED FOUL SEWER MANHOLE ●

**NOTES:**  
 ● PART VIII  
 ● OSI Map Ref: 5430-11

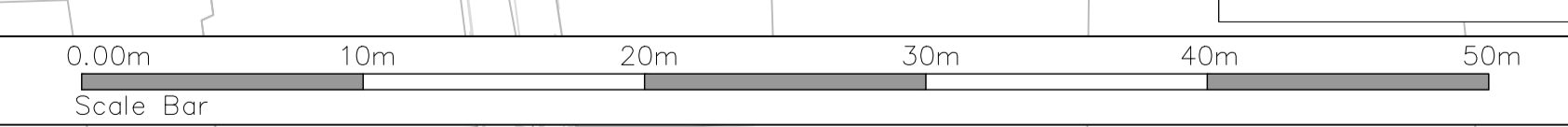

I:\gaur-bip-01\Work\_Town Urban Design\Drawings\DRMGT0491-RPS-00-XX-M2-C-DR0001 Part 6 Drainage.dwg

Client

**Comhairle Contae Thiobraid Árann**  
Tipperary County Council

**General Notes**

(i) Hard copies, dwf and pdf will form a controlled issue of the drawing. All other formats (dwg etc.) are deemed to be an uncontrolled issue and any work carried out based on these files is at the recipients own risk. RPS will not accept any responsibility for any errors from the use of these files, either by human error by the recipient, listing of the un-dimensioned measurements, compatibility with the recipients software, and any errors arising when these files are used to aid the recipients drawing production, or setting out on site.

(ii) DO NOT SCALE, use figured dimensions only.

(iii) This drawing is the property of RPS, it is a project confidential classified document. It must not be copied used or its contents divulged without prior written consent. The needs and expectations of client and RPS must be considered when working with this drawing.

(iv) Information including topographical survey, geotechnical investigation and utility detail used in the design have been provided by others.

(v) All Levels refer to Ordnance Survey Datum, Malin Head.

Rev	Date	Drn Chk	Amendment / Issue	App
P01	10.07.20	Me	PART VIII APPLICATION	RPS

Model File Identifier  
MGT0491

Scale	1:250 @ A1 1:500 @ A3	Project	CLONMEL TOWN URBAN DESIGN		
Created on	JULY 2020	Title	DRAINAGE		
Sheets	05 of 08	Drawing No.	DR000105	Status	S1
File Identifier	MGT0491-RPS-00-XX-DR-C-DR0001	Rev	P01		

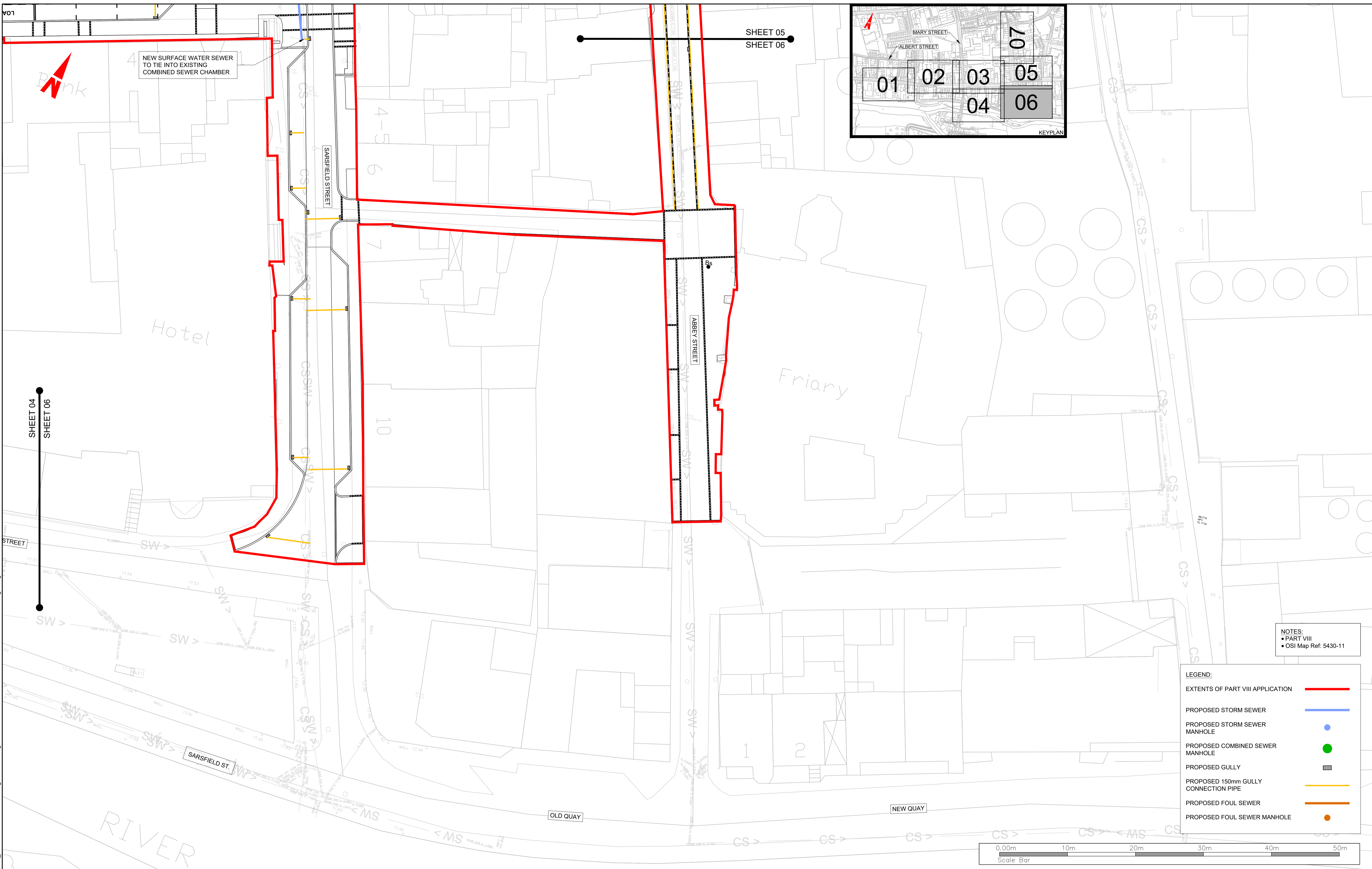

NEW SURFACE WATER SEWER TO TIE INTO EXISTING COMBINED SEWER CHAMBER

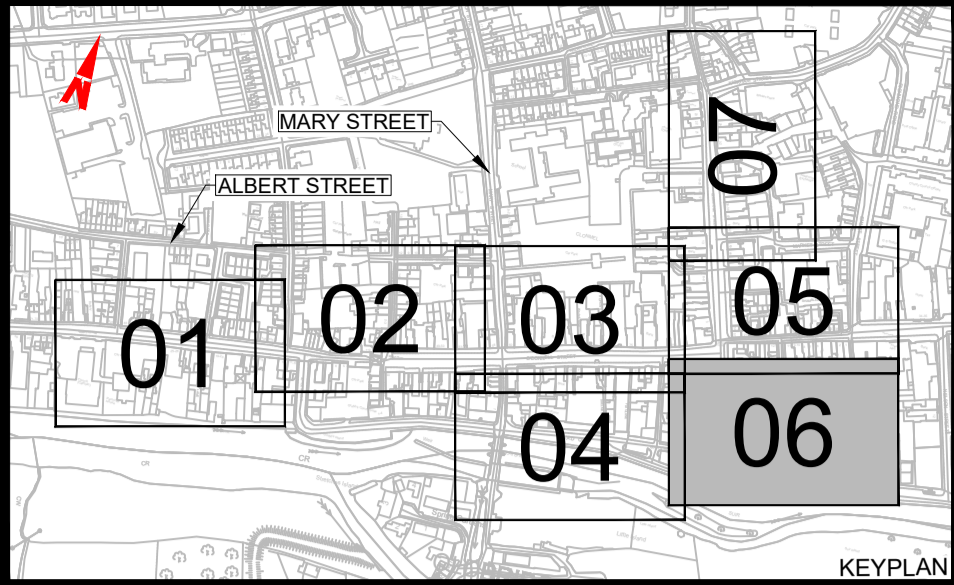

SHEET 04  
SHEET 06

SHEET 05  
SHEET 06

NOTES:  
 • PART VIII  
 • OSI Map Ref: 5430-11

**LEGEND:**

EXTENTS OF PART VIII APPLICATION	
PROPOSED STORM SEWER	
PROPOSED STORM SEWER MANHOLE	
PROPOSED COMBINED SEWER MANHOLE	
PROPOSED GULLY	
PROPOSED 150mm GULLY CONNECTION PIPE	
PROPOSED FOUL SEWER	
PROPOSED FOUL SEWER MANHOLE	

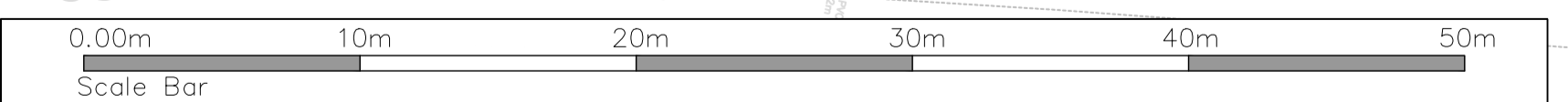

Client

**Comhairle Contae Thiobraid Árann**  
Tipperary County Council

**General Notes**

(i) Hard copies, dwf and pdf will form a controlled issue of the drawing. All other formats (dwg etc.) are deemed to be an uncontrolled issue and any work carried out based on these files is at the recipients own risk. RPS will not accept any responsibility for any errors from the use of these files, either by human error by the recipient, listing of the un-dimensioned measurements, compatibility with the recipients software, and any errors arising when these files are used to aid the recipients drawing production, or setting out on site.

(ii) DO NOT SCALE, use figured dimensions only.

(iii) This drawing is the property of RPS, it is a project confidential classified document. It must not be copied used or its contents divulged without prior written consent. The needs and expectations of client and RPS must be considered when working with this drawing.

(iv) Information including topographical survey, geotechnical investigation and utility detail used in the design have been provided by others.

(v) All Levels refer to Ordnance Survey Datum, Malin Head.

Rev	Date	Drawn By	Amendment / Issue	App
P01	10.07.20	Me	PART VIII APPLICATION	PS

Model File Identifier  
MGT0491

Scale	1:250 @ A1 1:500 @ A3
Created on	JULY 2020
Sheets	06 of 08

Project	CLONMEL TOWN URBAN DESIGN		
Title	DRAINAGE		
Drawing No.	Status	Rev	
DR000106	S1	P01	



NOTES:  
 • PART VIII  
 • OSI Map Ref. 5430-11

**LEGEND:**

EXTENTS OF PART VIII APPLICATION	
PROPOSED STORM SEWER	
PROPOSED STORM SEWER MANHOLE	
PROPOSED COMBINED SEWER MANHOLE	
PROPOSED GULLY	
PROPOSED 150mm GULLY CONNECTION PIPE	
PROPOSED FOUL SEWER	
PROPOSED FOUL SEWER MANHOLE	

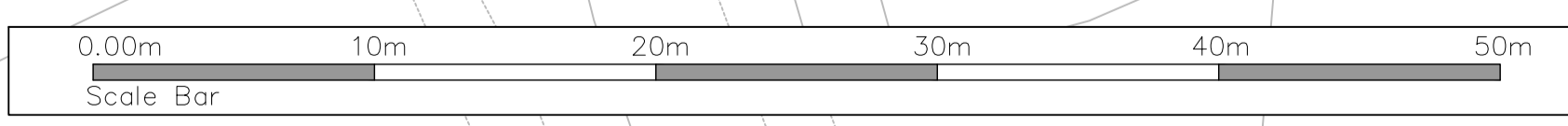

Client

**Comhairle Contae Thiobraid Árann**  
Tipperary County Council

**General Notes**

(i) Hard copies, dwf and pdf will form a controlled issue of the drawing. All other formats (dwg etc.) are deemed to be an uncontrolled issue and any work carried out based on these files is at the recipients own risk. RPS will not accept any responsibility for any errors from the use of these files, either by human error by the recipient, listing of the un-dimensioned measurements, compatibility with the recipients software, and any errors arising when these files are used to aid the recipients drawing production, or setting out on site.

(ii) DO NOT SCALE, use figured dimensions only.

(iii) This drawing is the property of RPS, it is a project confidential classified document. It must not be copied used or its contents divulged without prior written consent. The needs and expectations of client and RPS must be considered when working with this drawing.

(iv) Information including topographical survey, geotechnical investigation and utility detail used in the design have been provided by others.

(v) All Levels refer to Ordnance Survey Datum, Malin Head.

Rev	Date	Drawn By	Amendment / Issue	App
P01	10.07.20	MW	PART VIII APPLICATION	RS

Model File Identifier  
MGT0491

Scale	1:250 @ A1 1:500 @ A3
Created on	JULY 2020
Sheets	07 of 08

Project		CLONMEL TOWN URBAN DESIGN	
Title		DRAINAGE	
File Identifier	Drawing No.	Status	Rev
MGT0491-RPS-00-XX-DR-C-DR0001	DR0001-07	S1	P01