

**LEGEND**

- Site Boundary —
- Existing Foul Drainage — Ex FMH
- Existing Storm Drainage — Ex SMH
- Proposed Foul Drainage — FMH
- Proposed Storm Manhole ● SMH
- Proposed inspection chamber □
- Proposed Gully — G

**NOTES**

1. All works to be in accordance with councils specification and schedule of works and in compliance with current building regulations.
2. All works to be in accordance with the following document 'Irish Water - Connection and Developer Services - Water Infrastructure Standard Details August 2016'.

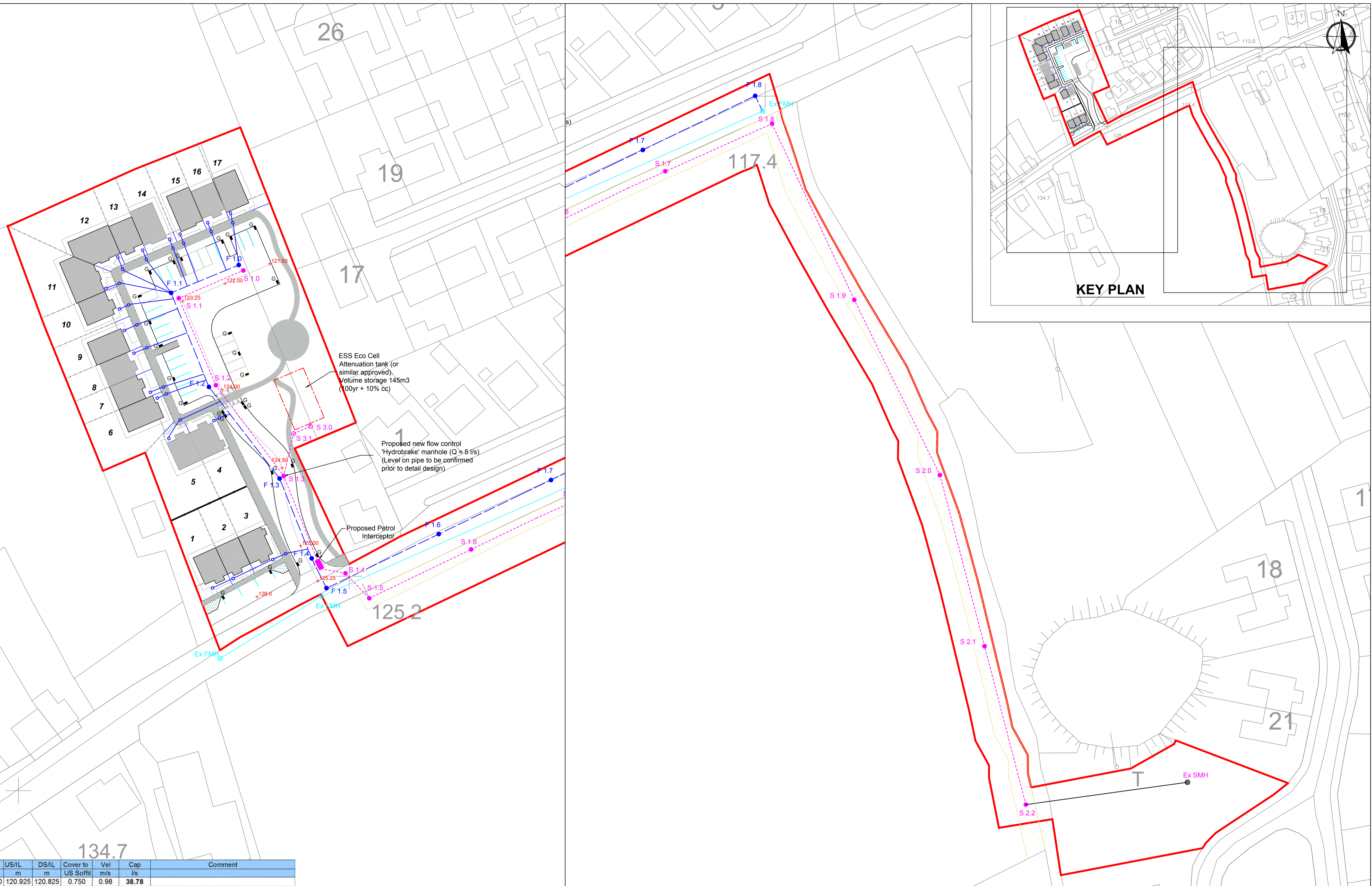

Upstream Sewer Ref	Length m	Dia mm	Grad 1 in	Fall m	US/CL m	US/IL m	DS/IL m	Cover to US Soffit m	Vel m/s	Cap l/s	Comment
S1.0 - S1.1	18	225	180	0.100	121.900	120.925	120.825	0.750	0.98	38.78	
S1.1 - S1.2	24	225	192	0.125	123.250	120.825	120.700	2.200	0.94	37.55	
S1.2 - S1.3	29	225	225	0.129	124.000	120.700	120.571	3.075	0.87	34.70	S1.3 Hydrabrake Manhole
S1.3 - PI*	25	225	225	0.111	124.500	120.571	120.460	3.704	0.87	34.67	*PI - Petrol Interceptor
PI* - S1.4	6	225	222	0.027	125.000	120.360	120.333	4.415	0.88	34.90	*PI - Petrol Interceptor
S1.4 - S1.5	9	225	225	0.040	125.250	120.333	120.293	4.692	0.87	34.68	
S1.5 - S1.6	29	300	225	0.129	124.500	120.293	120.164	3.907	1.05	74.25	
S1.6 - S1.7	29	300	193	0.150	123.000	119.500	119.350	3.200	1.13	80.07	Backdrop MH
S1.7 - S1.8	30	300	143	0.210	120.400	118.000	117.790	2.100	1.32	93.14	Backdrop MH
S1.8 - S1.9	50	300	225	0.222	118.840	117.790	117.568	0.750	1.05	74.18	
S1.9 - S2.0	50	300	227	0.220	119.300	117.568	117.348	1.432	1.04	73.85	
S2.0 - S2.1	45	300	225	0.200	119.897	117.348	117.148	2.249	1.05	74.22	
S2.1 - S2.2	42	300	225	0.187	120.400	117.148	116.961	2.952	1.05	74.28	
S2.2 - Ex Mh	42	300	225	0.187	120.800	116.961	116.774	3.539	1.05	74.22	
Ex MH	428				118.430	116.730					In green area of 'Drom Slinne' estate
S1.3 - S3.1	11	300	145	0.076	124.500	120.571	120.495	3.929	1.31	92.54	
S3.1 - S3.0	5	300	111	0.045	123.500	120.495	120.450	3.005	1.49	105.61	Proposed MC 3500 Stormtech attenuation tank required. Min cover over cell = 600mm. 850m³ Attenuation storage to be provided.
S3.0					123.500	120.450					

Sewer Ref	Length m	Dia mm	Grad 1 in	Fall m	US/CL m	US/IL m	DS/IL m	US Depth m	Vel m/s	Cap l/s	US Manhole Type	Notes
F1.0 - F1.1	19	225	150	0.13	121.900	120.925	120.798	0.75	0.93	37.10	Public	
F1.1 - F1.2	26	225	150	0.17	123.250	120.798	120.625	2.23	0.93	37.01	Public	
F1.2 - F1.3	30	225	150	0.20	124.000	120.625	120.425	3.15	0.93	37.05	Public	
F1.3 - F1.4	22	225	150	0.15	124.500	120.425	120.278	3.85	0.93	37.09	Public	
F1.4 - F1.5	8.5	225	149	0.06	125.000	120.278	120.221	4.50	0.93	37.16	Public	
F1.5 - F1.6	32	225	149	0.22	125.250	120.221	120.006	4.80	0.94	37.19	Public	
F1.6 - F1.7	32	225	64	0.50	123.000	119.700	119.200	3.08	1.43	56.72	Public	Assumed BD
F1.7 - F1.8	32	225	56	0.58	120.400	117.000	116.425	3.18	1.53	60.83	Public	Assumed BD
F1.8 - Ex MH	4	225	133	0.03	117.400	116.425	116.395	0.75	0.99	39.30	Public	

<b>Comhairle Contae Thiobraid Árann</b> Tipperary County Council				
<b>HOUSING SECTION</b> CIVIC OFFICES, EMMET STREET, CLONMEL, CO. TIPPERARY				
S. CARR DIRECTOR OF HOUSING		L. RYAN SENIOR EXECUTIVE ARCHITECT		
DRAWING TITLE: <b>Part 8 - Proposed housing at Portroe, Nenagh, Co. Tipperary</b> <b>FOUL &amp; STORM SYSTEMS</b>				
DRAWN BY: MO'C MAY, 2018	CHECKED BY: LR MAY, 2018	SCALE: 1: 500 @ A1	DWG NO: 22/PR/P8/08/01	